

The OB-7

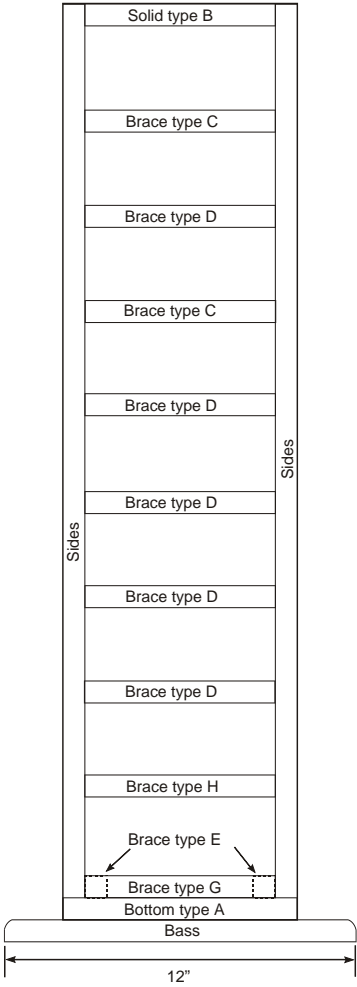

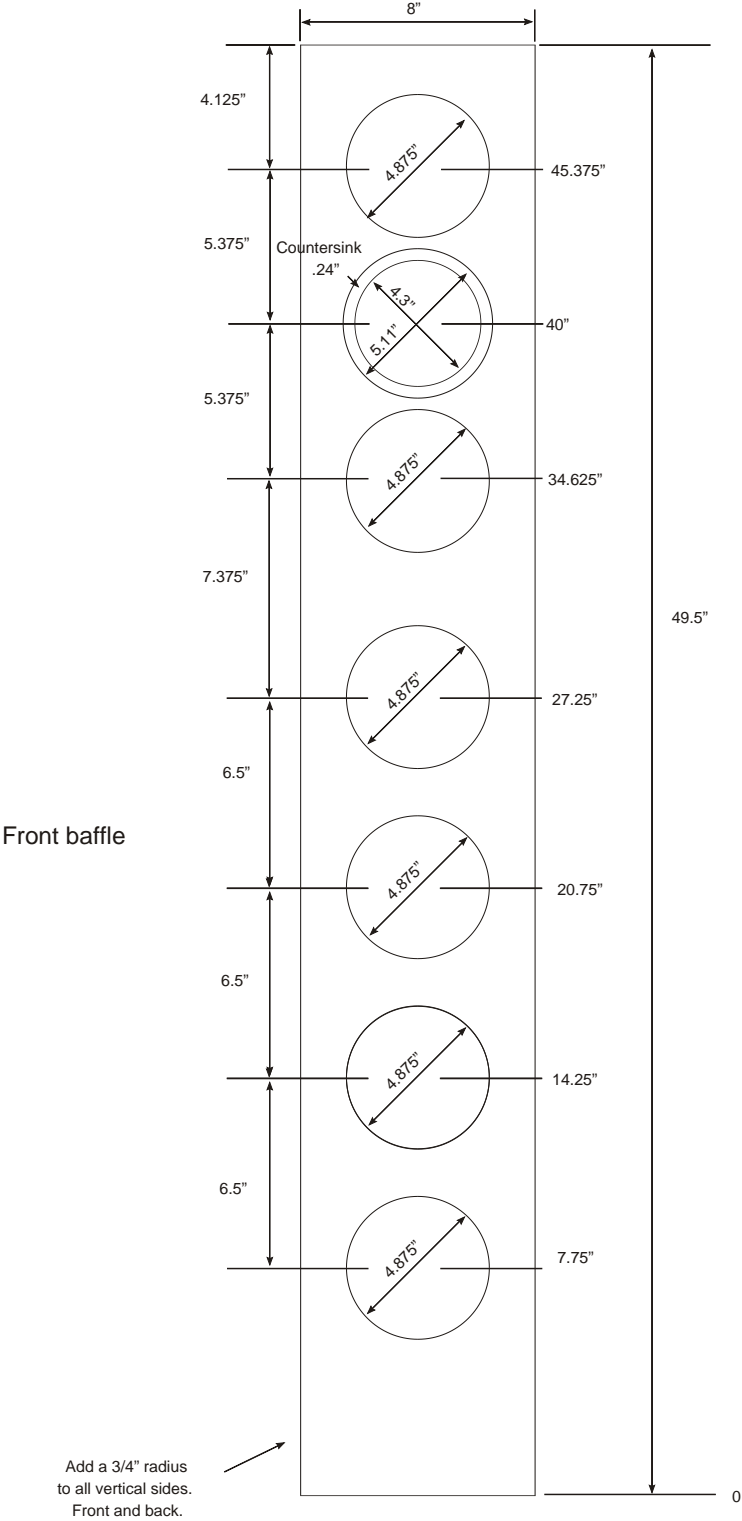
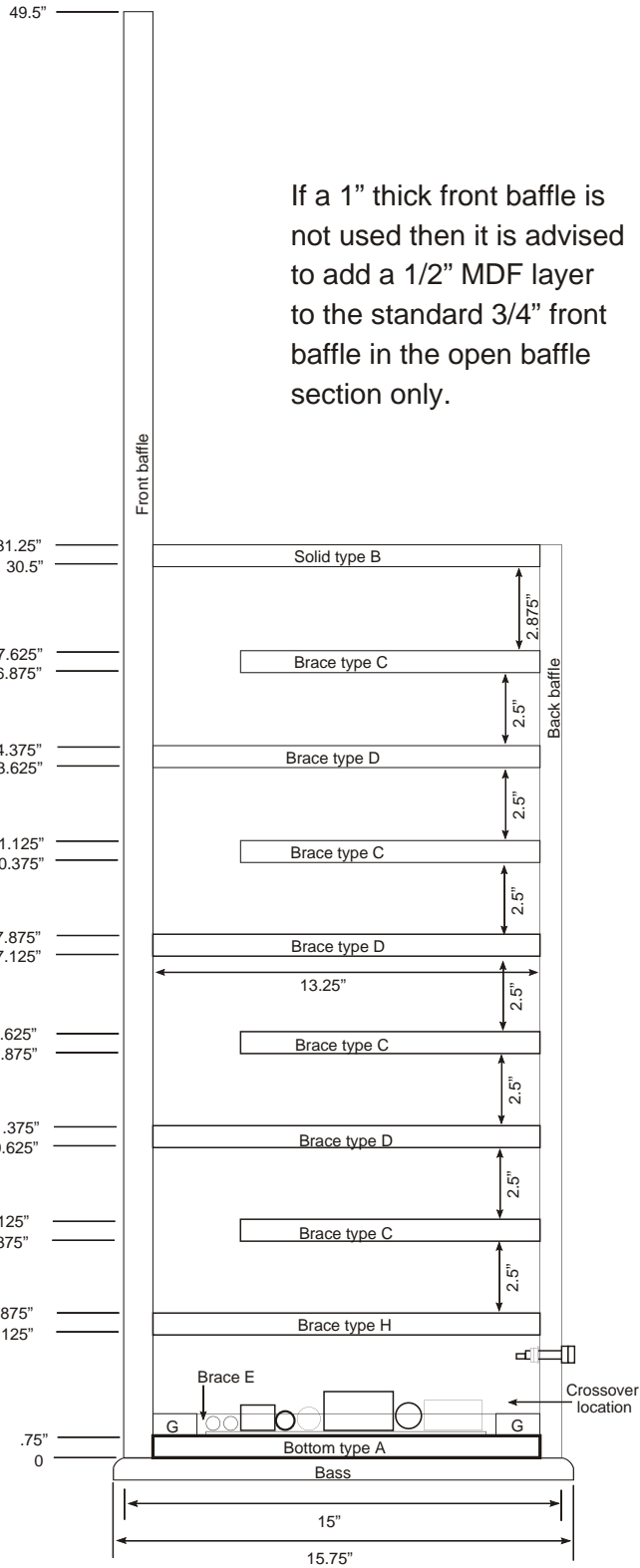

Cut List for straight top panel version

Front baffle: 49.5" x 8" x 1"

If 1" thick MDF is not available
then this could be made with two
layers of 1/2" MDF.

Rear baffle: 31.25" x 8" x 3/4"

Top and Bottom A and B: 13.25" x 8" x 3/4"

Sides 30.5" x 13.25" by 3/4"

Brace type C: 10.25" x 6.5" x 3/4"

Brace type D and H: 13.25" x 6.5" x 3/4"

Brace type E: 10.25" x 3/4" x 3/4"

Brace type G: 6.5" x 1.5" by 3/4"

Bass 15.75" by 12"

Bottom type A

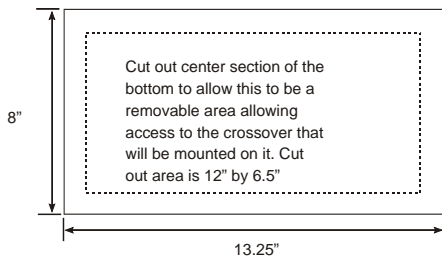

Bottom type A

Bottom view.

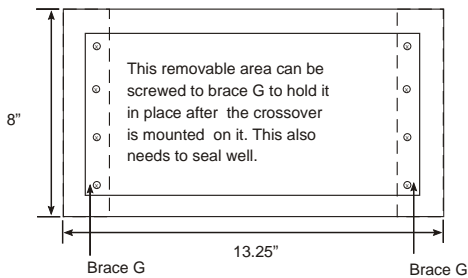

Brace type H

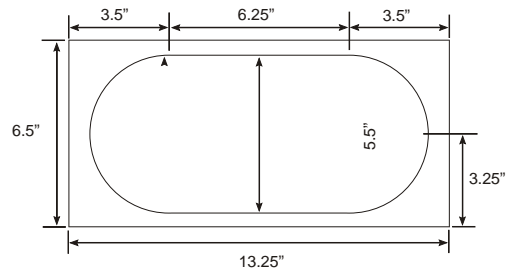

Brace type C

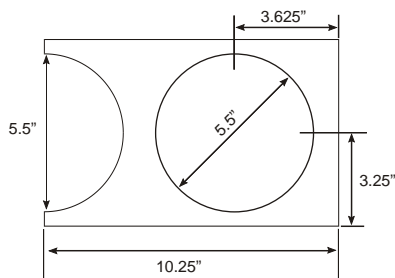

Brace type D

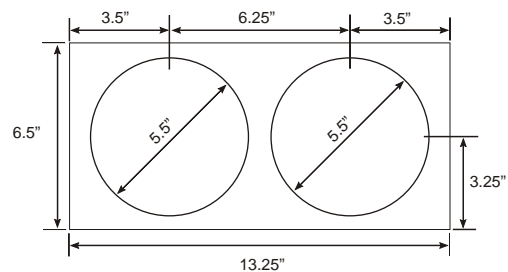

To add a little character the top of the woofer chamber can be slanted 8 degrees.

If building it this way it is easier to allow the sides and back to come up over the slanted top panel. The Excess can then be trimmed away and smooth flush by going over it with a straight cut bit in a router.

